

SAMSARA

PHUKET ISLAND



the Headland

Laem Thip headland, meaning Heavenly Point in Thai, is the setting for Samsara. On this stunning jungled promontory, washed by ocean breezes, and flanked on both side by white sandy beaches, 14 luxurious villas will share a tropical haven of peace and seclusion, overlooking the blue sun-kissed Andaman Sea.

Samsara — a truly unique location
— prepare to be captivated.



the Homes

The 14 Samsara villas combine easy-going tropical living with the amenities of the 21st century. Thanks to variations in slope, outlook, tree cover and bedrock strata, each of the three villa designs, Unchan, Malila and Suraya is adapted differently for each site. There is, in addition, considerable scope for adaptations to meet individual requirements and, beyond this, you can specify extensive internal and external customisation of layout, materials, fittings and other features. Homes to dream about – a sanctuary for the senses.

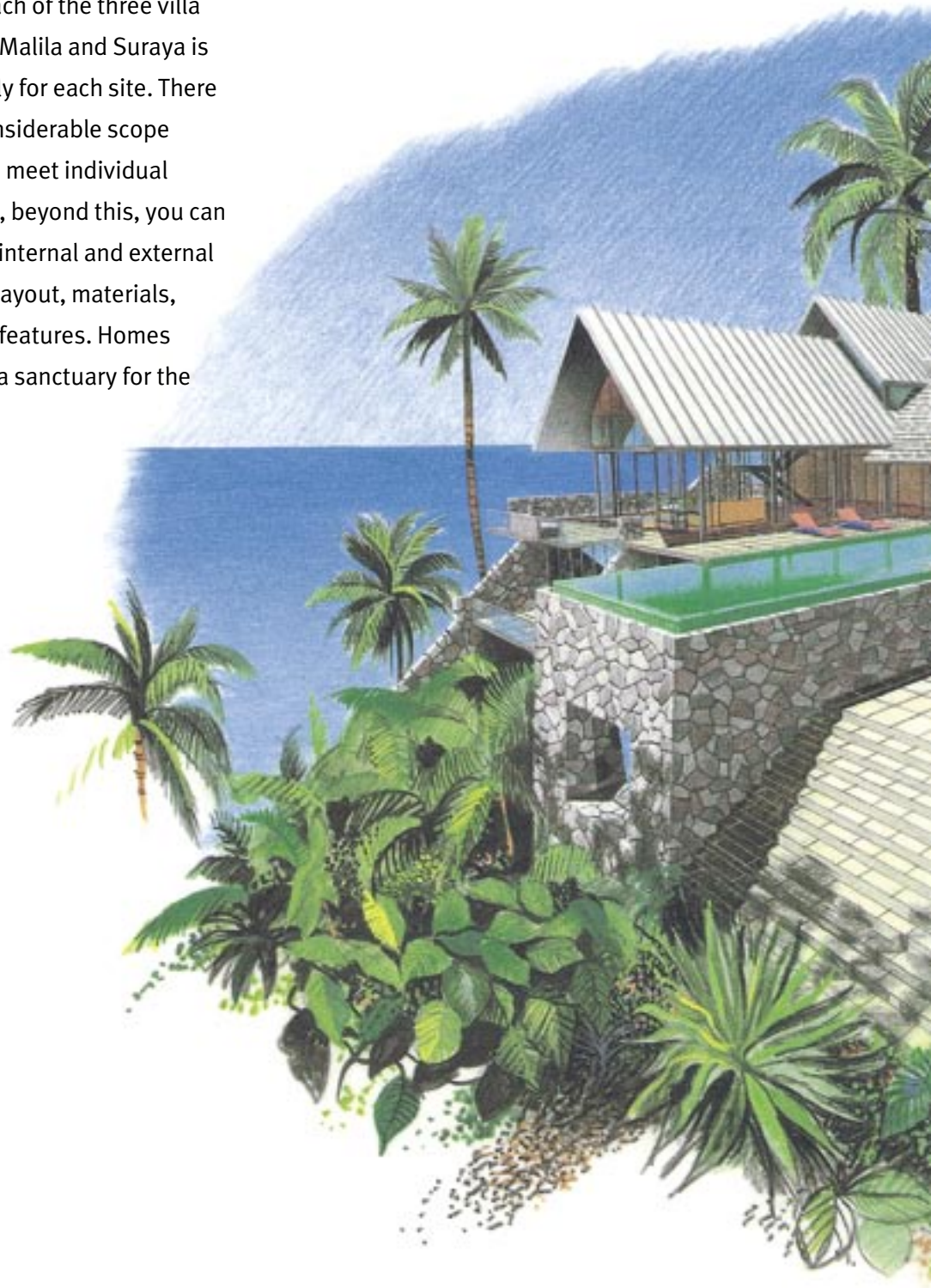



the Site

Reaching out into the sea, at the northern end of Patong Bay, Samsara lies in quiet seclusion on a 1.5 km private drive through tropical jungle.

But seclusion does not mean isolation: your home is less than ten minute's drive from Patong, Phuket's main resort and entertainment area and just thirty minutes from Phuket Town, the Boat Lagoon and the International airport.





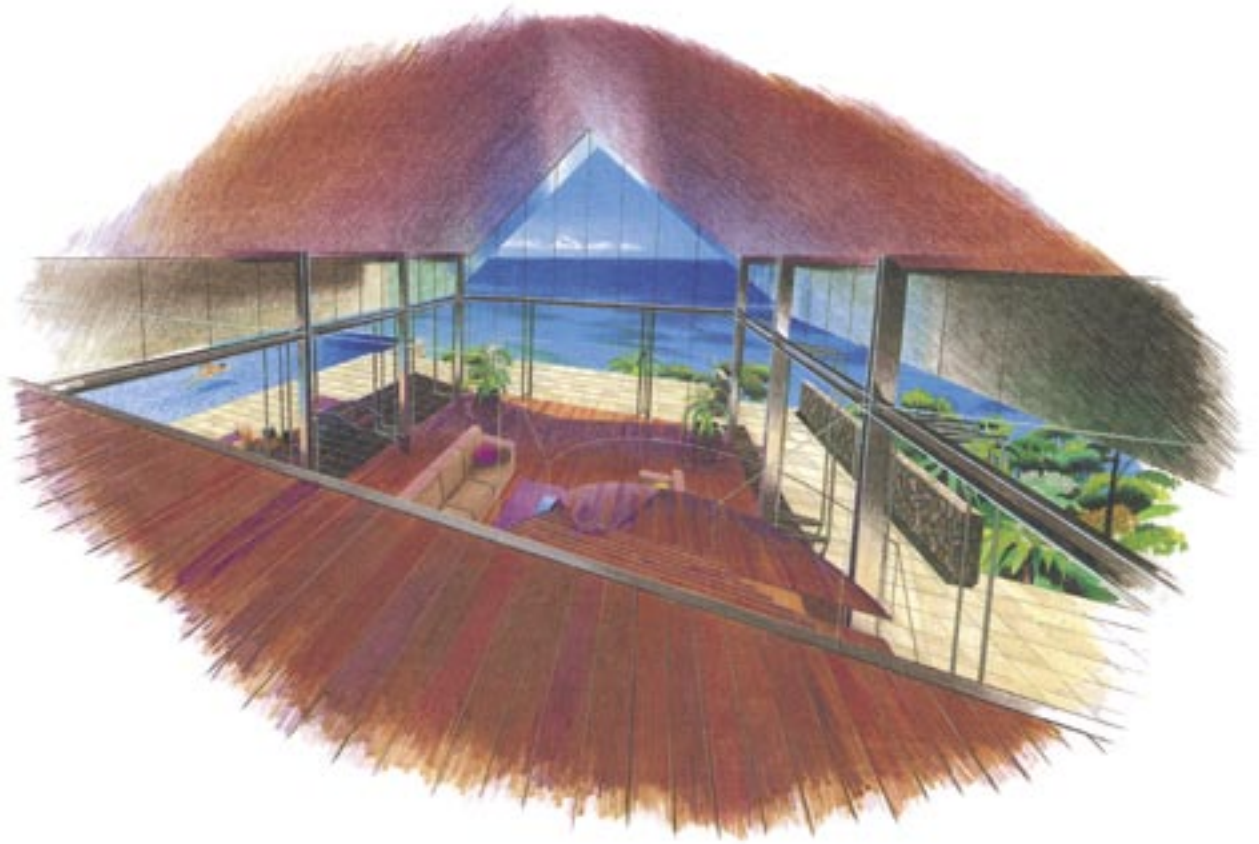

the Interiors

Spaces that collude, rather than collide.
An almost seamless transition from interior to exterior, a gallery of glass walls displaying the breathtaking art of nature itself, pure and unadorned. tropical greens, sunlight and stunning seascapes. An unforgettable panorama. The blue, blue sky , expansive slow-burning sunsets, distant electric storms, moonlight on a cobalt sea. But inside, the tranquillity of a private space, security, comfort and favourite things.

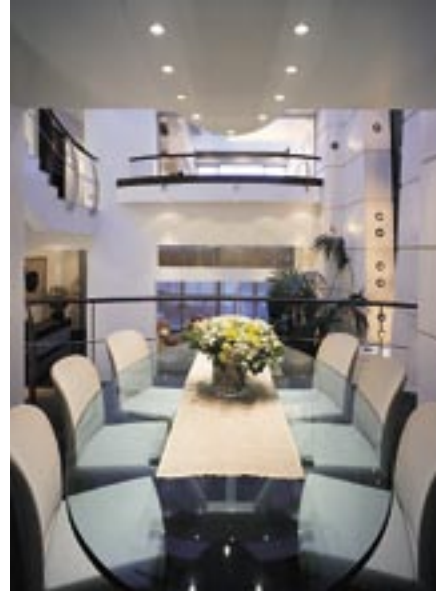

the Island

The tropical island of Phuket has, in the last decade, become Asia's premier destination, for European and Asian visitors alike. Combining a unique mix of modern upscale facilities, and Thai traditions. Phuket encompasses golden beaches, world class golf courses, Island yachting, superb restaurants and some of Asia's most exclusive beach resorts. Phuket also has less-sophisticated attractions — unspoiled areas of wild coast, tropical islands and forested hills, far from the madding crowd and, ever present, the gift of the Thai people themselves; gentle, friendly, easy going and always welcoming.



But this is more than just a holiday island. Phuket has averaged 17% GDP growth over the last ten years. And a newly elected, forward-looking administration is rapidly bringing the island's infrastructure up to first-world standards. Centrally located in Asia, politically stable, with an enviable lifestyle, modern communications, international schools and hospitals, and an international airport that puts most major cities in Asia within an hour or two, Phuket is increasingly the preferred first-home location for regional business people.



the Team

developer

Asia Island Homes Inc.

Baan Chai Nam – a boutique estate of beachfront villas and apartments, on beautiful Bangtao Bay, Surin Springs – a small community of modern villas and apartments set around a natural spring-fed lake near Surin Beach and now Samsara, the third flagship development. Asia Island Homes – select locations, outstanding architecture, premium quality. Residential properties in S.E. Asia

info@asiaislandhomes.com www.asiaislandhomes.com



project manager

F.C.S. Group

architect

Original Vision

civil & structural engineers

**Meinhardt (Thailand) Limited
Hewitt Structural Services Limited**

mechanical & electrical engineers

**E.F.S.I. Limited
Supersolutions Limited**

quantity surveyor

Gleeds (Thailand) Limited

